



1 JALAN KILANG

1 Jalan Kilang is located along Jalan Bukit Merah, and easily accessible to Ayer Rajah and Central expressways, which connect to various parts of Singapore.

1 Jalan Kilang
Singapore 159402





Ceiling Height (Maximum Height)

- Floor to slab soffit
- 2nd storey: 6.3 m
- 3rd - 6th storey: 3.8 m
- 7th storey: 5.0 m

Column Grid

- Approx. 8.0 m x 8.4 m

Lifts

- Passenger lifts: 2 x 900 kg (13 persons)
- Cargo lifts: 2 x 3,000 kg
- Dimension: 2.4 m (W) x 2.1 m (D) x 2.7 m (H)
- Lift car door size: 2.0 m (W) x 2.7 m (H)

Loading Bay Facilities

- 2 loading/unloading bays

Parking Lots

- Car: Approx. 30
- Motorcycle: Approx. 11
- Lorry: Approx. 1
- Parking lot allocation: 1 lot per 500 sqm leased

Air-conditioning system

- Self-controlled air-conditioning system

Power Supply Allocation

- Approx. 250 watts per sqm of lettable area

Provisions

- Fire detector
- Closed circuit TV system

Amenities

- Food centre, shopping facilities, fastfood outlets, MRT, bus interchange, library and banking facilities

ACCESSIBILITY

- Easily accessible to Ayer Rajah and Central Expressways and Central Business District
- Proximity to Commonwealth, Redhill MRT stations and Bukit Merah Bus Interchange

BUILDING SPECIFICATIONS

Type of Building

- 6-storey hi-specs industrial building with basement carpark
- BCA Green Mark Certified
- Green features: Motion-sensor lightings, toilets with water saving fittings, and recycling corner

Floor Area

- Total NLA: Approx. 6,071 sqm

Floor Loading

- 2nd storey: 15.0 kN/sqm
- 3rd - 7th storey: 10.0 kN/sqm

TYPICAL FLOOR PLAN

- Leasable Area
- Common Services
- ▲ Passenger Lift
- Cargo Lift
- Toilet

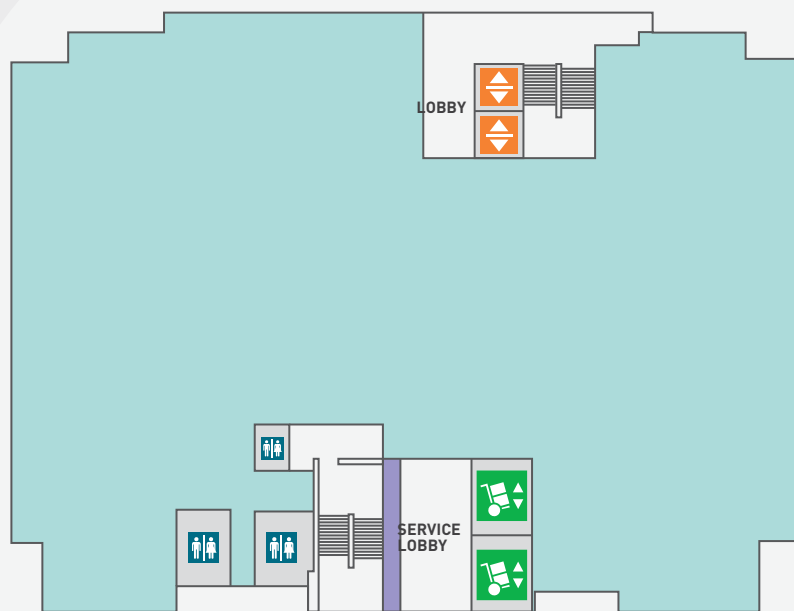

Leasing Enquiries sg.marketing@capitaland.com [6508 8686](tel:65088686) [9757 7000](tel:97577000) (message-only service available on weekdays from 8.30am to 6pm)

Disclaimer

The Developer makes no representations or warranties, conditions, undertakings or terms either expressed or implied as to the condition, quality, accuracy, fitness for purpose, completeness of the information contained herein or that such information will be accurate, up to date, or free from error. All art renderings and pictures herein are artist's impressions only and all specifications stated herein are subject to re-survey and approval from the relevant authorities. The information and specifications contained herein do not form part of an offer or a contract and neither the Developer nor their appointed Marketing Agents can be held for any inaccuracies, changes, losses or damages arising therefrom.