



5 TOH GUAN ROAD EAST

5 Toh Guan Road East, located near the upcoming Jurong Lake District, is a commercial hub with a vibrant mix of office, retail, residential, hotel, and entertainment serving Singapore's western region.

It comprises two buildings - a three-storey warehouse cum five-storey ancillary office building, and a four-storey warehouse. They are suitable for mid-sized distribution companies.

5 Toh Guan Road East
Singapore 608831





Ceiling Height

Floor to floor

- Block 1
 - Ancillary Office
 - 1st storey: 4.4 m
 - 2nd storey: 3.0 m
 - 3rd storey: 3.1 m
 - 4th storey: 3.1 m
 - 5th storey: 4.4 m
 - Warehouse
 - 1st storey: 6.3 m
 - 2nd storey: 6.2 m
 - 3rd storey: 6.0 m
- Block 2
 - Warehouse
 - 1st storey: 7.8 m
 - 2nd storey: 7.6 m
 - 3rd storey: 6.0 m
 - 4th storey: 6.4 m

Lifts

- Block 1
 - Passenger lift: 1 x 750 kg (11 persons)
 - Cargo lifts: 3 x 6,000 kg
 - Dimension: 4.12 m (W) x 3.55 m (D) x 2.8 m (H)
 - Lift car door size: 4.0 m (W) x 2.8 m (H)
- Block 2
 - Passenger lift: 1 x 750 kg (11 persons)
 - Cargo lifts: 3 x 6,000 kg
 - Dimension: 3.85 m (W) x 3.58 m (D) x 3.0 m (H)
 - Lift car door size: 3.8 m (W) x 3.0 m (H)

Loading Bay Facilities

- Block 1
 - 12 loading/unloading bays
- Block 2
 - 5 loading/unloading bays

Parking Lots

- Car: Approx. 27
- Lorry: Approx. 12

Power Supply Allocation

- 300 amps per floor

Provisions

- 24-hour security surveillance
- Closed circuit TV system

Amenities

- Walking distance to canteen and IMM

ACCESSIBILITY

- Within a minute's drive to Pan-Island Expressway and 5 minutes' drive to Ayer Rajah Expressway
- 2 minutes' drive from Jurong East MRT station

BUILDING SPECIFICATIONS

Type of Building

- Block 1 – 3-storey warehouse cum ancillary office space
- Block 2 – 4-storey warehouse space

Floor Area

- Total NLA: Approx. 23,495 sqm

Typical Floor Plate

- Warehouse (Blk 1 and 2): Approx. 21,000 sqm
- Ancillary Office (Blk 1): Approx. 2,500 sqm

Floor Loading

- Block 1
 - Ancillary Office: 5.0 kN/sqm
 - Warehouses
 - 1st storey: 25.0 kN/sqm
 - 2nd storey: 20.0 kN/sqm
 - 3rd storey: 15.0 kN/sqm
- Block 2
 - Warehouses: 15.0 kN/sqm

TYPICAL FLOOR PLAN

- Leasable Warehouse
- Leasable Ancillary Office
- Area Passenger Lift
- Cargo Lift
- Toilet

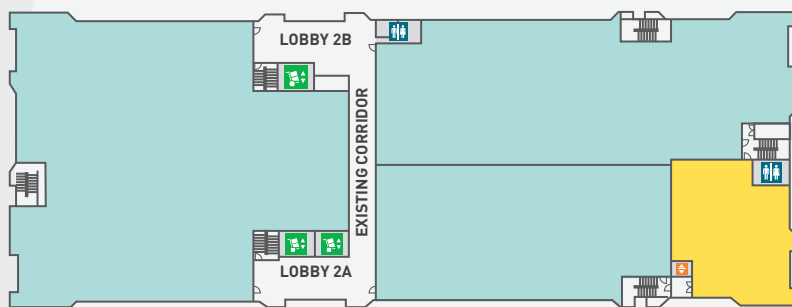

Block 1

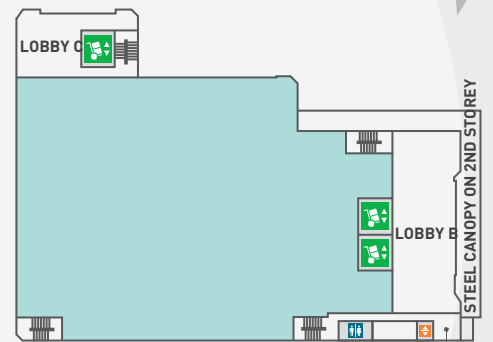

Block 2

LOBBY A

Leasing Enquiries marketing@capitaland.com

6508 8686

9757 7000 (message-only service available on weekdays from 8.30am to 6pm)

Disclaimer

The Developer makes no representations or warranties, conditions, undertakings or terms either expressed or implied as to the condition, quality, accuracy, fitness for purpose, completeness of the information contained herein or that such information will be accurate, up to date, or free from error. All art renderings and pictures herein are artist's impressions only and all specifications stated herein are subject to re-survey and approval from the relevant authorities. The information and specifications contained herein do not form part of an offer or a contract and neither the Developer nor their appointed Marketing Agents can be held for any inaccuracies, changes, losses or damages arising therefrom.