



# 17 CHANGI BUSINESS PARK CENTRAL 1

17 Changi Business Park Central 1 is located in the iconic Changi Business Park (CBP), home to the world's leading companies in the Financial Service and Technology, Research & Development, High- Technology, Software Design & Development sectors and industries.

17 Changi Business Park Central 1  
Singapore 486073

Strategically situated major expressways, and within walking distance to Expo MRT station and Changi City Point retail mall, this 6-storey business park building offers a premium business space with an excellent address.





### ACCESSIBILITY

- Easy access to Pan-Island Expressway and East Coast Parkway
- Walking distance to Expo MRT station and 20 minutes' drive to Central Business District
- Changi Business Park (CBP) is served by public bus service nos. 20, 47, 117, 118 and private buses to various estates in Singapore
- Sheltered pedestrian walkways connecting buildings in CBP

### BUILDING SPECIFICATIONS

#### Type of Building

- 6-storey business park building with basement carpark
- BCA Green Mark GoldPlus Award
- Green features: End-of-trip facilities, eco-friendly interior fittings and materials, motion-sensor lightings, toilets with water saving fittings and recycling corner

#### Floor Area

- Total NLA: Approx. 14,299 sqm

#### Typical Floor Plate

- 1st storey: Approx. 2,268 sqm
- 2nd - 6th storey: Approx. 2,536 sqm

#### Floor Loading

- 1st & 2nd storey: 7.5 kN/sqm
- 3rd - 6th storey: 5.0 kN/sqm

#### Ceiling Height

- Level 1 and 2, Floor to Ceiling Board Height: 3.4 m  
- Floor to Soffit: 4.7 m
- Level 3 to 6, Floor to Ceiling Board Height: 2.8 m  
- Floor to Soffit: 4 m

#### Column Grid

- Approx. 10.8 m x 9.0 m to 10.8 m x 12.0 m

#### Lifts

- Passenger lifts: 3 x 1,350 kg (20 persons)
- Service lift: 2 x 3,000 kg  
- Dimension 2.7 m (W) x 3.0 m (D) x 2.9 m (H)  
- Lift car door size: 2.1 m (W) x 2.7 m (H)

#### Loading Bay Facilities

- 2 loading/unloading bays with dock levellers

#### Parking Lots

- Car: Approx. 187
- Motorcycle: Approx. 14
- Parking lot allocation: 1 lot per 200 sqm leased

#### Air-conditioning System

- Provided from Mon to Fri (8am - 6pm) except for Sat, Sun & Public Holidays

#### Air-conditioning Charges

- After office hours: \$88 per hour per AHU
- Chilled water supply is available (subject to terms and conditions)

#### Power Supply Allocation

- Approx. 150 watts or 0.25 amps per sqm of lettable area (3-Phase)

#### Provisions

- Common wet pantry (near the toilet behind passenger lift)
- Ceiling board and lighting
- 24-hour security surveillance

#### Amenities

- Changi City Point: 20,000 sqm of retail and dining offerings
- Hotels/Service Residences: Park Avenue Changi Hotel and Capri by Fraser
- Other amenities within CBP: convention centre, clinics, childcare centres, supermarkets and etc

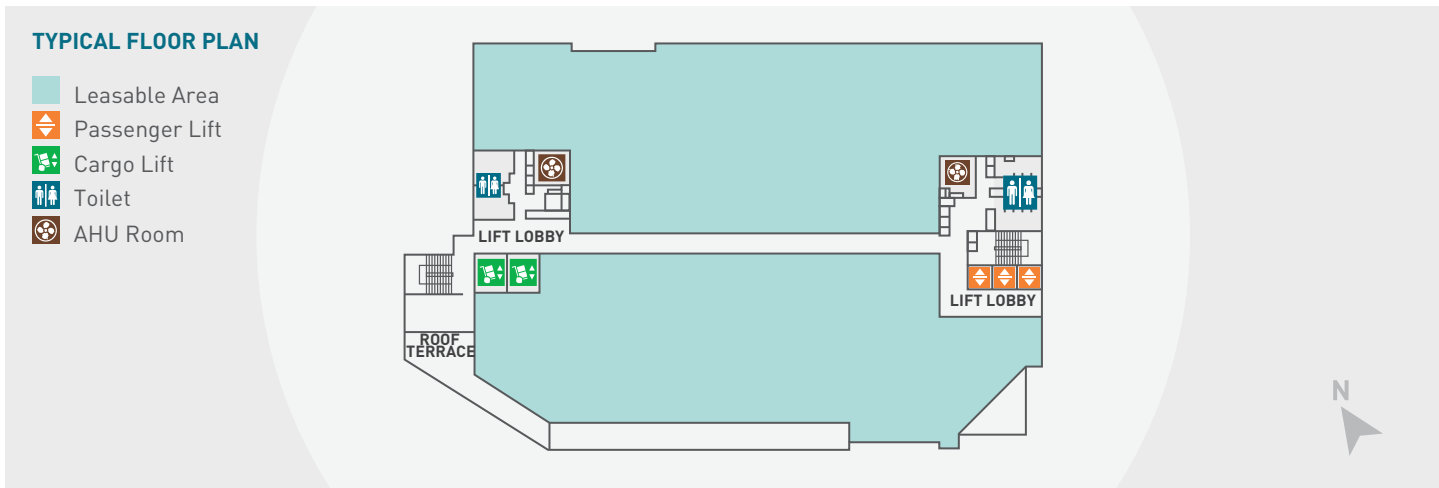

Leasing Enquiries [✉ sg.marketing@capitaland.com](mailto:sg.marketing@capitaland.com) [☎ 6508 8686](tel:65088686) [☎ 9757 7000](tel:97577000) (message-only service available on weekdays from 8.30am to 6pm)

#### Disclaimer

The Developer makes no representations or warranties, conditions, undertakings or terms either expressed or implied as to the condition, quality, accuracy, fitness for purpose, completeness of the information contained herein or that such information will be accurate, up to date, or free from error. All art renderings and pictures herein are artist's impressions only and all specifications stated herein are subject to re-survey and approval from the relevant authorities. The information and specifications contained herein do not form part of an offer or a contract and neither the Developer nor their appointed Marketing Agents can be held for any inaccuracies, changes, losses or damages arising therefrom.