



# TAMPINES BIZ-HUB

---

Tampines Biz-Hub is a four-storey multi-tenanted industrial building located five minutes from the Pan-Island Expressway. Ideal for companies in light industries, it offers a quick and cost-efficient way to jump start business.

11 Tampines Street 92  
Singapore 528872





- Annex block
  - 1st storey: 20.0 kN/sqm
  - 2nd & 3rd storey: 15.0 kN/sqm
  - 4th storey: 4.0 kN/sqm

#### Ceiling Height

- Floor to floor
  - Main block
    - 1st storey: 4.5 m
    - 2nd - 4th storey: 4 m
  - Annex block
    - 1st & 2nd storey: 8.0 m
    - 3rd storey: 4.5 m
    - 4th storey: 3.5 m

#### Column Grid

- Approx. 8.0 m x 8.0 m

#### Lifts

- Main block
  - Passenger lifts: 2 x 900 kg (13 persons)
  - Service lift: 1 x 1,500 kg
    - Dimension: 2.15 m (W) x 2.1 m (D) x 3.0 m (H)
    - Lift car door size: 2.0 m (W) x 2.67 m (H)
- Annex block
  - Passenger lift: 1 x 750 kg (11 persons)
  - Cargo lifts: 2 x 4,000 kg
    - Dimension: 2.88 m (W) x 2.8 m (D) x 2.6 m (H)
    - Lift car door size: 2.6 m (W) x 2.6 m (H)

#### Loading Bay Facilities

- Main block: 5 loading/unloading bays with 2 dock levellers
- Annex block: 5 loading/unloading bays with 5 dock levellers

#### Parking Lots

- Car: Approx. 124 (106 open surface & 18 sheltered)
- Motorcycle: Approx. 20
- Parking lot allocation: 1 lot per 200 sqm leased

#### Power Supply Allocation

- Approx. 60 amps for typical 200 sqm unit (3-Phase)

#### Provisions

- 24-hour security surveillance
- Heat and smoke detector
- Fibre-optic ready

#### Amenities

- Shuttle service to nearby eateries during lunch time

#### ACCESSIBILITY

- 5 minutes' drive to Pan-Island Expressway and 15 minutes' drive to Singapore Changi Airport
- 5 minutes' drive to Tampines West MRT stations
- Easy access to Tampines bus interchange
- Shuttle service between Tampines Industrial Park A to Tampines MRT Station provided by HDB

#### BUILDING SPECIFICATIONS

##### Type of Building

- 4-storey flatted factory

##### Floor Area

- Total NLA: Approx. 14,458 sqm

##### Floor Loading

- Main block
  - 1st storey: 10.0 kN/sqm
  - 2nd storey: 7.5 kN/sqm
  - 3rd & 4th storey: 5.0 kN/sqm

#### TYPICAL FLOOR PLAN

- Leasable Area
- ⇄ Passenger Lift
- S Service Lift
- 🚚 Cargo Lift
- 🚻 Toilet

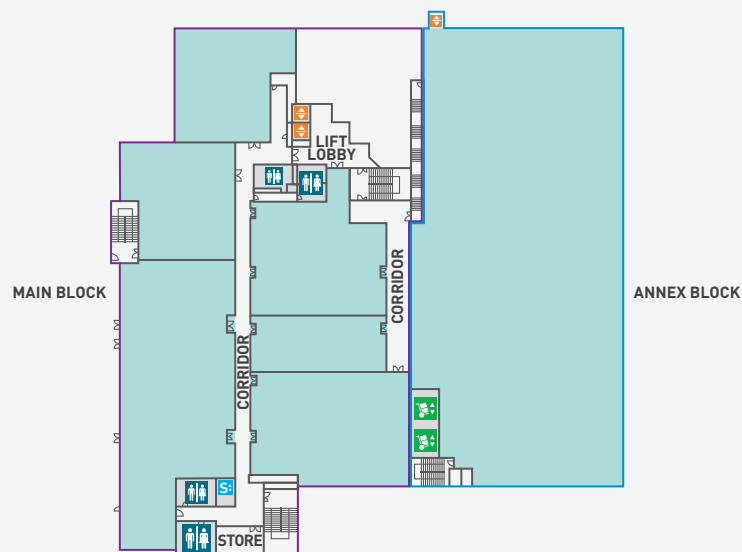

Leasing Enquiries: 6508 8686 or [sg.marketing@capitaland.com](mailto:sg.marketing@capitaland.com)

#### Disclaimer

The Developer makes no representations or warranties, conditions, undertakings or terms either expressed or implied as to the condition, quality, accuracy, fitness for purpose, completeness of the information contained herein or that such information will be accurate, up to date, or free from error. All art renderings and pictures herein are artist's impressions only and all specifications stated herein are subject to re-survey and approval from the relevant authorities. The information and specifications contained herein do not form part of an offer or a contract and neither the Developer nor their appointed Marketing Agents can be held for any inaccuracies, changes, losses or damages arising therefrom.