



7 INTERNATIONAL BUSINESS PARK

Located within International Business Park, the five-storey 7 International Business Park provides an ideal environment for businesses that need functional layout and building specifications. The building is located in the neighbourhood of high-tech companies engaging in information software development, research and high-tech manufacturing, laboratory testing and data processing activities.

7 International Business Park
Singapore 609919



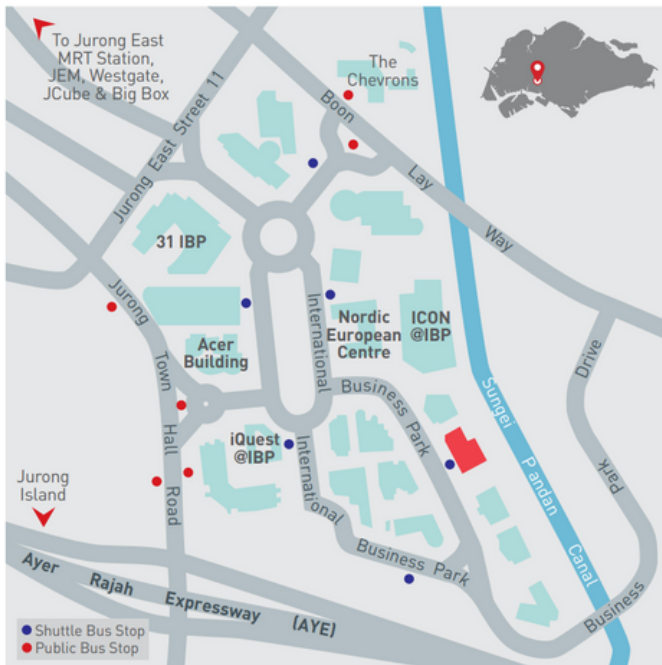

Floor Loading

- 1st - 2nd storey: 10.0 kN/sqm
- 3rd storey: 7.5 kN/sqm
- 4th - 5th storey: 4.0 kN/sqm

Ceiling Height

- Floor to floor
 - Basement: 3.5 m
 - 1st - 3rd storey: 5.0 m
 - 4th storey: 3.7 m
 - 5th storey: 2.6 to 4.6 m

Lifts

- Passenger lift: 1 x 750 kg (11 persons)
- Cargo lifts: 2 x 2,500 kg
 - Dimensions: 2.38 m (W) x 2.39 m (D) x 2.3 m (H)
 - Lift car door size: 1.8 m (W) x 2.3 m (H)

Loading Bay Facilities

- 3 loading/unloading bays with dock levellers

Parking Lots

- Car: Approx. 58
- Parking lot allocation: 1 lot per 200 sqm leased

Air-conditioning System

- Central air-con system from Mon to Fri (8am to 5.30pm) and on Sat (8am to 1pm) except Public Holidays

Air-conditioning Prices

- Applicable after office hours
 - Weekday (after 5.30pm), Saturday (after 1pm), Sunday & Public Holidays: \$40 per AHU, subject to 2 AHUs

Power Supply Allocation

- Approx. 182 watts or 0.31 amps per sqm of lettable area

Provisions

- Closed circuit TV system

Amenities

- Proximity to developments such as JEM, Westgate, Big Box, the Devan Nair Institute for Employment & Employability and Genting Hotel Jurong.

ACCESSIBILITY

- Located next to Jurong Lake District, a commercial hub with a vibrant mix of office, retail, residential, hotel and entertainment
- Within 5 minutes' drive to Jurong East MRT station
- 5 minutes' drive from Ayer Rajah Expressway (AYE)
- 15 minutes' drive to City and 30 minutes' drive to Singapore Changi Airport via AYE

Shuttle Bus Services

- Provided by JTC to Jurong East MRT station

BUILDING SPECIFICATIONS

Type of Building

- 5-storey building with 1 level of basement car park

Floor Area

- Total NLA: Approx 9,079 sqm

Typical Floor Plate

- 1st storey: Approx. 2,656 sqm
- 2nd storey: Approx. 2,252 sqm
- 3rd storey: Approx. 1,337 sqm
- 4th - 5th storey: Approx. 1,333 sqm

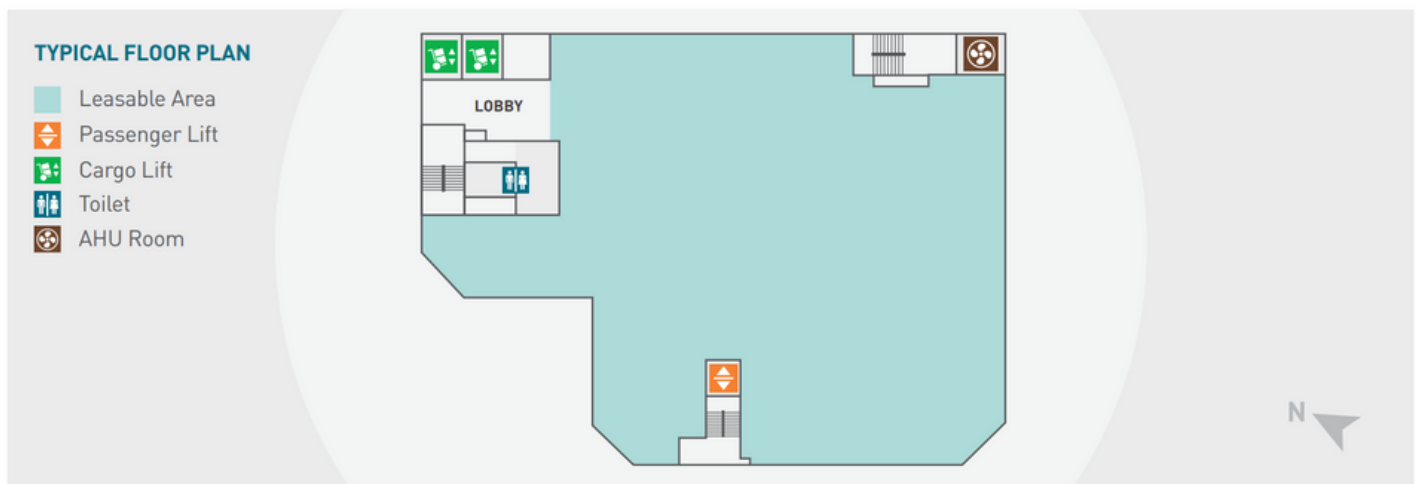

Leasing Enquiries [✉ sg.marketing@capitaland.com](mailto:sg.marketing@capitaland.com) [☎ 6508 8686](tel:65088686) [☎ 9757 7000](tel:97577000) (message-only service available on weekdays from 8.30am to 6pm)

Disclaimer

The Developer makes no representations or warranties, conditions, undertakings or terms either expressed or implied as to the condition, quality, accuracy, fitness for purpose, completeness of the information contained herein or that such information will be accurate, up to date, or free from error. All art renderings and pictures herein are artist's impressions only and all specifications stated herein are subject to re-survey and approval from the relevant authorities. The information and specifications contained herein do not form part of an offer or a contract and neither the Developer nor their appointed Marketing Agents can be held for any inaccuracies, changes, losses or damages arising therefrom.