



UBI BIZ-HUB

Ubi Biz-Hub is located in the Ubi Industrial area in eastern Singapore. It is a six-storey light industrial factory with ancillary offices ideal for manufacturing, test laboratories, R&D, product design and development.

150 Ubi Ave 4
Singapore 408825





ACCESSIBILITY

- Within 5 minutes' drive to Pan-Island Expressway
- 15 minutes' drive to city and 20 minutes' drive to Singapore Changi Airport

BUILDING SPECIFICATIONS

Type of Building

- 6-storey purpose-built factory with basement carpark

Floor Area

- Total NLA: Approx. 10,697 sqm

Floor Loading

- 1st storey: 5.0 kN/sqm
- 2nd & 3rd storey: 12.5 kN/sqm
- 4th - 6th storey: 7.5 kN/sqm

Ceiling Height

- Floor to floor
 - 1st storey: 5.3 m
 - 2nd & 3rd storey: 6.0 m
 - 4th - 6th storey: 4.5 m

Column Grid

- Approx. 10.0 m x 13.0 m

Lifts

- Passenger lifts: 2 x 1,000 kg (15 persons)
- Cargo lifts: 2 x 3,000 kg
 - Dimension: 2.8 m (W) x 3.1 m (D) x 3.0 m (H)
 - Lift car door size: 2.4 m (W) x 2.7 m (H)

Loading Bay Facilities

- 3 loading/unloading bays with dock levellers

Parking Lots

- Car: Approx. 80 (60 basement & 20 open surface)
- Parking lot allocation: 1 lot per 200 sqm leased

Power Supply Allocation

- Approx. 300 amps per floor (3-Phase)

Amenities

- Food outlets within 3 minutes' walk

TYPICAL FLOOR PLAN

- Leasable Warehouse Area
- Leasable Ancillary Office
- Passenger Lift
- Cargo Lift
- Toilet

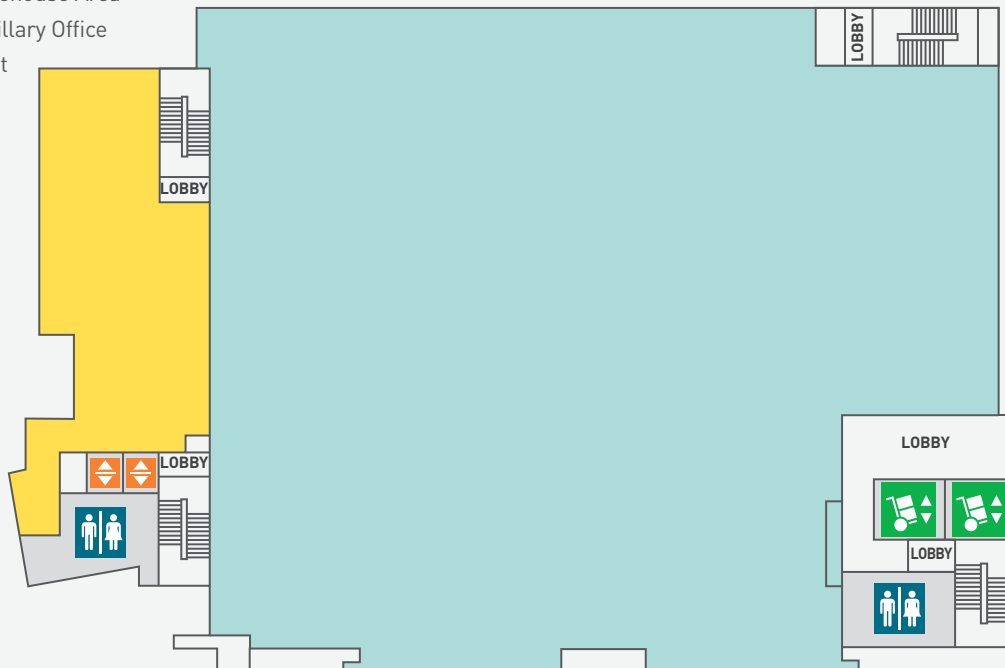

Leasing Enquiries: 6508 8686 or sg.marketing@capitaland.com

Disclaimer

The Developer makes no representations or warranties, conditions, undertakings or terms either expressed or implied as to the condition, quality, accuracy, fitness for purpose, completeness of the information contained herein or that such information will be accurate, up to date, or free from error. All art renderings and pictures herein are artist's impressions only and all specifications stated herein are subject to re-survey and approval from the relevant authorities. The information and specifications contained herein do not form part of an offer or a contract and neither the Developer nor their appointed Marketing Agents can be held for any inaccuracies, changes, losses or damages arising therefrom.