



## iQUEST@IBP

---

Located within International Business Park, the five-storey iQuest@IBP provides an idea environment for business that needs functional layout and building specifications. It also caters to business that needs to support their manufacturing operations in Jurong and Tuas industrial estates.

27 International Business Park  
Singapore 609924



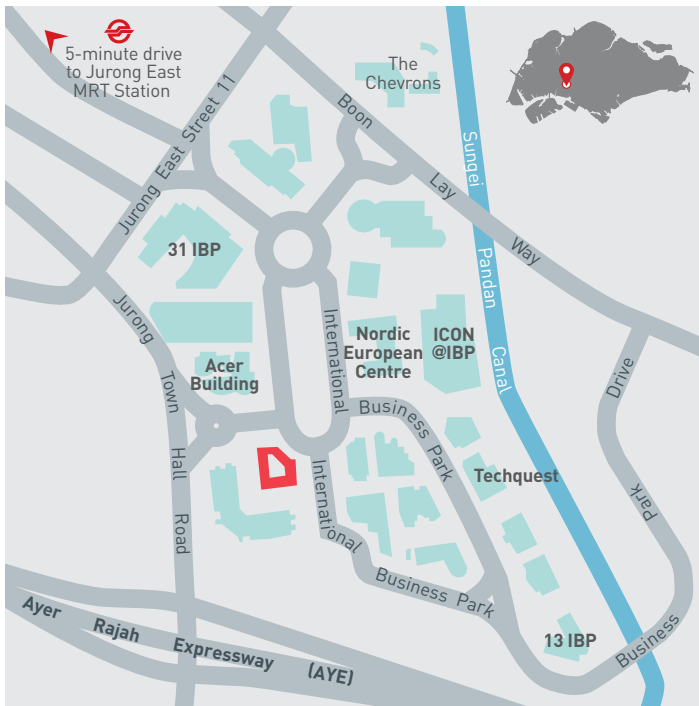

#### Typical Floor Plate

- Approx. 2,166 sqm

#### Floor Area

- Total NLA: Approx. 9,123 sqm

#### Floor Loading

- 1st storey: 7.5 kN/sqm
- 2nd - 5th storey: 5.0 kN/sqm & 7.5 kN/sqm

#### Ceiling Height

- Floor to Floor
  - 1st storey: 4.5 m
  - 2nd - 5th storey: 3.2 m

#### Column Grid

- Approx. 8 m x 8 m

#### Lifts

- Passenger lifts: 2 nos. x 900 kg (13 persons)
- Cargo lifts: 2 nos. x 2,500 kg
  - Dimension: 2.5 m (W) x 3.0 m (D) x 2.7 m (H)
  - Lift car door size: 1.8 m (W) x 2.49 m (H)

#### Loading Bay Facilities

- 3 loading/unloading bays with 2 dock levellers

#### Parking Lots

- Car: Approx. 74
- Parking lot allocation: 1 lot per 200 sqm leased

#### Air-conditioning System

- Spilt unit air-con or VRV system

#### Provisions

- 24-hour security surveillance
- Closed circuit TV system

#### Amenities

- Childcare centre within building. Café, food court, gym and clinic in neighbouring buildings

#### ACCESSIBILITY

- Located next to upcoming Jurong Lake District, a commercial hub with a vibrant mix of office, retail, residential, hotel and entertainment
- Within 5 minutes' drive to Jurong East MRT Station
- 5 minutes' drive from Ayer Rajah Expressway (AYE)
- 15 minutes' drive to City and 30 minutes' drive to Singapore Changi Airport via AYE

#### Shuttle Bus Service

- Provided by JTC to Jurong East MRT Station

#### BUILDING SPECIFICATIONS

##### Type of Building

- A 5-storey multi-tenanted business park building with a basement car park
- Ideal environment for business that needs functional layout and building specifications

#### TYPICAL FLOOR PLAN

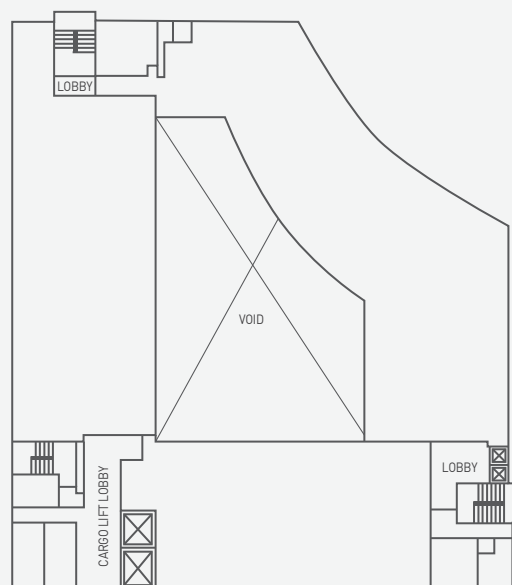

Lease Enquiries: 6508 8686 or [sg.marketing@capitaland.com](mailto:sg.marketing@capitaland.com)

#### Disclaimer

The Developer makes no representations or warranties, conditions, undertakings or terms either expressed or implied as to the condition, quality, accuracy, fitness for purpose, completeness of the information contained herein or that such information will be accurate, up to date, or free from error. All art renderings and pictures herein are artist's impressions only and all specifications stated herein are subject to re-survey and approval from the relevant authorities. The information and specifications contained herein do not form part of an offer or a contract and neither the Developer nor their appointed Marketing Agents can be held for any inaccuracies, changes, losses or damages arising therefrom.