



PACIFIC TECH CENTRE

Pacific Tech Centre is a fully air-conditioned ten-storey Hi-Specs industrial building located along Jalan Bukit Merah.

1 Jalan Kilang Timor
Singapore 159303

It is also accessible to Ayer Rajah and Central Expressways which connects to various parts of Singapore.



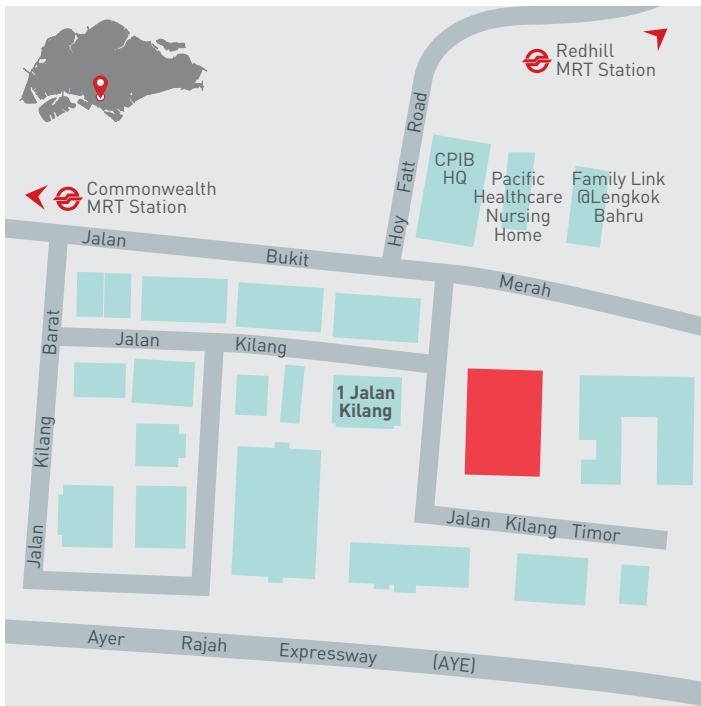

Ceiling Height

- Floor to floor
 - 1st & 3rd storey: 6.0 m
 - 2nd storey: 4.0 m
 - 4th - 10th storey: 4.0 m
- Floor to false ceiling
 - 1st & 3rd storey: 4.5 m
 - 2nd storey: 2.7 m
 - 4th - 10th storey: 2.7 m

Column Grid

- Approx. 8.4 m x 16.8 m

Lifts

- Passenger lifts: 3 x 1,000 kg (15 persons)
- Firemen lift: 1 x 1,000 kg (15 persons)
- Cargo lifts: 3 x 2,000 kg
 - Dimension: 1.8 m (W) x 2.8 m (D) x 2.5 m (H)
 - Lift car door size: 1.8 m (W) x 2.5 m (H)

Loading Bay Facilities

- 4 loading/unloading bays with dock levellers

Parking Lots

- Car: Approx. 166
- Motorcycle: Approx. 7
- Lorry: Approx. 4
- Parking lot allocation: 1 lot per 400 sqm leased

Air-conditioning System

- Ceiling cassette type and VRV spilt air-conditioning unit

Power Supply Allocation

- Approx. 175 watts or 0.3 amps per sqm of lettable area (3-Phase)

Provisions

- 24-hour security surveillance
- Closed circuit TV system
- Common wet pantry
- Fibre-optics to MDF room

Amenities

- Walking distance to food centre, shopping facilities, fastfood outlets, MRT, bus interchange, library and banking facilities

ACCESSIBILITY

- Easily accessible to Ayer Rajah, Central Expressways and to Central Business District
- Proximity to Commonwealth, Redhill MRT stations and Bukit Merah Bus Interchange

BUILDING SPECIFICATIONS

Type of Building

- 10-storey high-specs industrial building with surface carpark & sheltered carpark at 2nd and 3rd storey

Floor Area

- Total NLA: Approx. 19,627 sqm

Floor Loading

- 1st storey: 15.0 kN/sqm
- 2nd & 3rd storey: 10.0 kN/sqm
- 4th - 9th storey: 5.0 kN/sqm
- 10th storey: 5.0 kN/sqm, 2.5 kN/sqm at entrance and airwell

TYPICAL FLOOR PLAN

- Leasable Area
- Common Services
- Passenger Lift
- Cargo Lift
- Firemen Lift
- Toilet

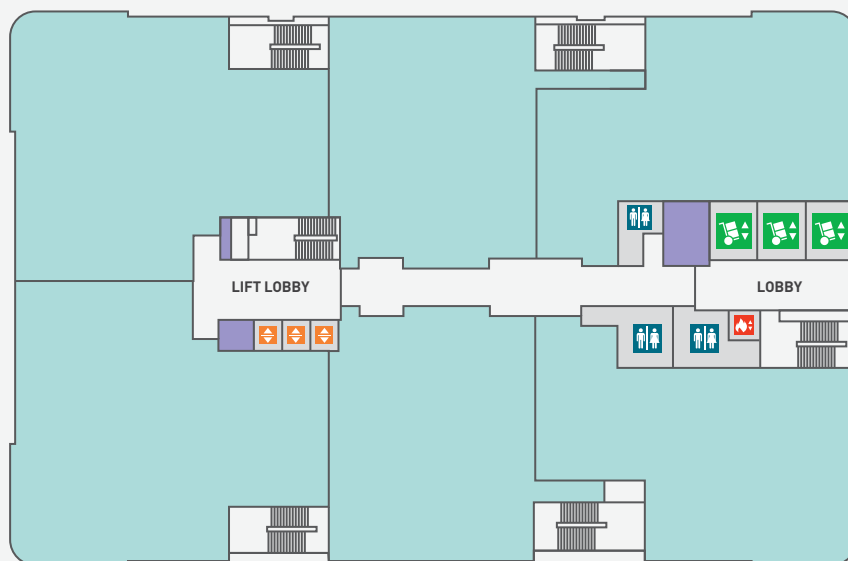

Leasing Enquiries: 6508 8686 or sg.marketing@capitaland.com

Disclaimer

The Developer makes no representations or warranties, conditions, undertakings or terms either expressed or implied as to the condition, quality, accuracy, fitness for purpose, completeness of the information contained herein or that such information will be accurate, up to date, or free from error. All art renderings and pictures herein are artist's impressions only and all specifications stated herein are subject to re-survey and approval from the relevant authorities. The information and specifications contained herein do not form part of an offer or a contract and neither the Developer nor their appointed Marketing Agents can be held for any inaccuracies, changes, losses or damages arising therefrom.