



THE SIEMENS CENTRE

The Siemens Centre comprises three buildings – the 15- and 8- storey towers, and a 2-storey annex block for amenities. It is suitable for companies in the semi-conductor and information technology industries which require provisions for high specifications development.

60 MacPherson Road
Singapore 348615



- Floor to false ceiling
 - 8-Storey Tower
 - 1st storey: 2.62 m
 - 2nd storey: 2.45 m - 2.64 m
 - 3rd - 8th storey: 2.61 m
 - 15-Storey Tower
 - 1st storey: 2.69 m
 - 2nd - 15th storey: 2.7 m

Floor Area

- Total NLA: Approx 27,781 sqm

Floor Loading

- 8-Storey Tower
 - 1st - 8th storey: 10.0 kN/sqm
 - Roof level 9: 10.0 kN/sqm
- 15-Storey Tower
 - 1st - 8th storey: 5.0 kN/sqm
 - 9th & 10th storey: 7.5 kN/sqm
 - 11th - 15th storey: 5.0 kN/sqm
 - Roof level 16: 7.5 kN/sqm
- 2-Storey Annex Block
 - 1st & 2nd storey: 5.0 kN/sqm
 - Roof level 3: 1.5 kN/sqm

Lifts

- 8-Storey Tower
 - Passenger lifts: 2 x 1,360 kg (20 persons)
 - Cargo lift: 1 x 5,000 kg
 - Dimension: 3.0 m (W) x 3.4 m (D) x 2.7 m (H)
 - Lift car door size: 2.5 m (W) x 2.3 m (H)
- 15-Storey Tower
 - Passenger lifts: 4 x 1,000 kg (15 persons)
 - Firemen lift: 1 x 1,350 kg (20 persons)

Loading Bay Facilities

- 1 loading/unloading bay

Parking Lots

- Car: Approx. 388 (254 basement, 134 open surface)
- Parking lot allocation: 1 lot per 200 sqm leased

Air-Conditioning System

- Central air-conditioning system
- Air-con provided from Mon to Fri (8am - 6pm) except Public Holidays
Charges apply outside standard operating hours at \$100 per hour

Power Supply Allocation

- Approx. 0.18 amps per sqm of lettable area

Provision

- 24-hour security surveillance
- Closed circuit TV system
- Fibre-optics ready

Amenities

- Cafeteria

ACCESSIBILITY

- Within 5 minutes' drive to Pan-Island Expressway
- Easily accessible to Central Expressway
- 10 minutes' drive to city and 20 minutes' drive to Singapore Changi Airport
- Walking distance to Potong Pasir MRT station

BUILDING SPECIFICATIONS

Type of Building

- An industrial office/research facility comprising three buildings, two towers of 15 storeys and 8 storeys each, and a 2-storey annex block with amenities

Ceiling Height

- Floor to floor
 - 8-Storey Tower
 - 1st storey: 3.41 m - 7.0 m
 - 2nd storey: 3.18 m - 3.39 m
 - 3rd - 8th storey: 3.4 m
 - 15-Storey Tower
 - 1st storey: 6.34 m
 - 2nd - 15th storey: 3.36 m

TYPICAL FLOOR PLAN (8-Storey block)

- Leasable Area
- Common Services
- Passenger Lift
- Cargo Lift
- Toilet

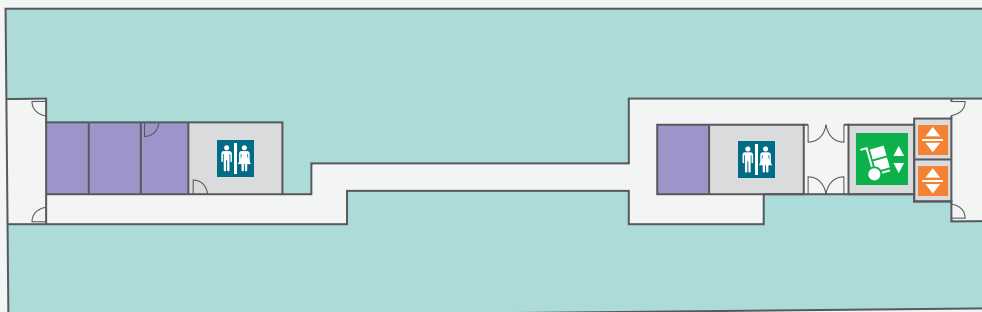

For enquiries, please contact our marketing team at 6508 8686