



CHADWICK, CURIE & CAVENDISH

Located in Singapore Science Park 1, Chadwick, Curie and Cavendish are three buildings in bare shell conditions offering maximum flexibility and cost efficiencies.

They are ideal for businesses ranging from wet laboratories to software development, IT services and even data centres.

Well-connected via the Ayer Rajah Expressway and with Kent Ridge MRT Station at its doorstep, Singapore Science Park 1 is easily accessible for the working community. Tenants are also able to enjoy the wide range of amenities such as restaurants, cafes, food court, childcare, gym, swimming pool, functions rooms and auditorium within the park.

83 Science Park Drive
Singapore Science Park 1
Singapore 118258



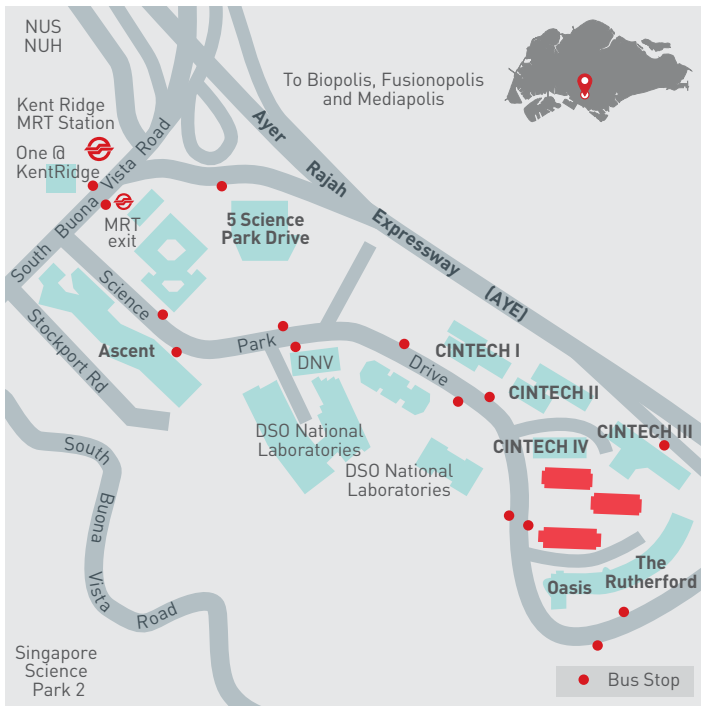

LOCATION

- The Chadwick
81 Science Park Drive, Singapore Science Park 1, Singapore 118257
- The Curie
83 Science Park Drive, Singapore Science Park 1, Singapore 118258
- The Cavendish
85 Science Park Drive, Singapore Science Park 1, Singapore 118259

ACCESSIBILITY

- Within 5 minutes' drive from National University of Singapore (NUS)
- 15 minutes' drive from Central Business District and from Clementi or Buona Vista MRT Stations
- 5 minutes' walk to bus stop with bus no. 92 and Science Park shuttle service
- 15 minutes' walk to Kent Ridge MRT Station

Shuttle Services

- Buses for shuttle services to the following places are conveniently located in front of the buildings:
 - Singapore Science Park 1 & 2, NUS and Kent Ridge MRT Station (\$0.40 per trip)

BUILDING SPECIFICATIONS

Type of Building

- 4-storey research building with modular column free units enabling flexible space planning and cost efficiency

Type of Premises

- Research unit:
Bare unit ideal for any R&D activities from wet laboratory to software development and IT set-ups

Floor Area

- The Chadwick - Total NLA: Approx. 6,450 sqm
- The Curie - Total NLA: Approx. 6,510 sqm
- The Cavendish - Total NLA: Approx. 7,710 sqm

Door Size

- Approx. 1.8 m x 2.1 m

Floor Loading

- 12.5 kN/sqm per floor

Ceiling Height

- Floor to slab soffit: 4.5 m

Column Grid

- The Chadwick/The Curie
 - 1st storey: Approx. 14.2 m x 28.8 m per unit
Approx. 14.2 m x 21.6 m per unit
 - 2nd - 4th storey: Approx. 5.0 m x 28.8 m per unit
- The Cavendish
 - 1st storey: Approx. 14.2 m x 36.0 m per unit
Approx. 28.4 m x 36.0 m per unit
 - 2nd - 4th storey: Approx. 14.2 m x 36.0 m per unit

Lifts

- The Chadwick/The Curie
Passenger/Service lift: 1 x 2,500 kg
- The Cavendish
Passenger/Service lifts: 2 x 2,500 kg
- Dimension: 2.71 m (W) x 1.85 m (D) x 2.4 m (H)
- Lift car door size: 1.9 m (W) x 2.19 m (H)

Loading Bay Facilities

- 1 loading/unloading area for each building

Provisions

- Service duct risers leading to roof top

Parking Lots

- Car: Approx. 161
- Parking lot allocation: One lot per 100 sqm leased

Amenities

- Meeting rooms, auditorium and fitness centre with swimming pool at Oasis
- Food and Beverage outlets available at Ascent, Cintech I, Oasis and One@KentRidge
- Retail shops and supermarket at One@KentRidge

TYPICAL FLOOR PLAN

- Leasable Area
- 🚶 Passenger Lift
- 🚻 Toilet
- 🌀 AHU Room

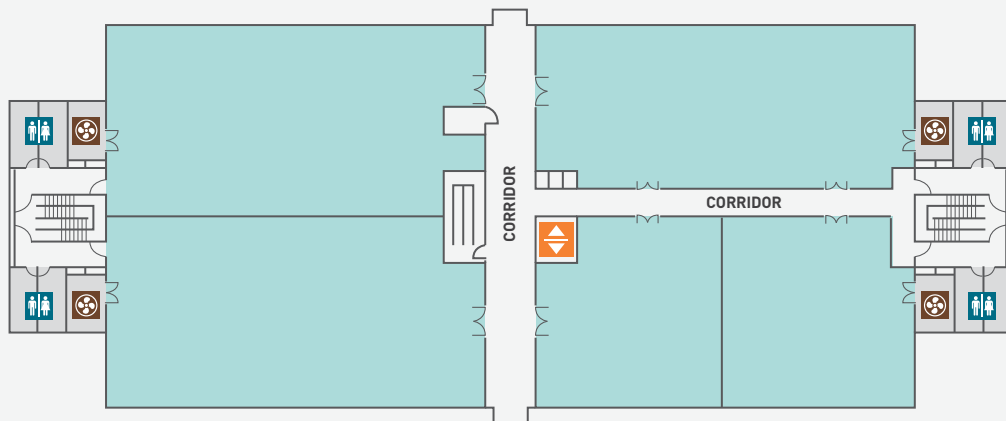

Leasing Enquiries sg.marketing@capitaland.com ☎ 6508 8686 📱 9757 7000 (message-only service available on weekdays from 8.30am to 6pm)

Disclaimer

The Developer makes no representations or warranties, conditions, undertakings or terms either expressed or implied as to the condition, quality, accuracy, fitness for purpose, completeness of the information contained herein or that such information will be accurate, up to date, or free from error. All art renderings and pictures herein are artist's impressions only and all specifications stated herein are subject to re-survey and approval from the relevant authorities. The information and specifications contained herein do not form part of an offer or a contract and neither the Developer nor their appointed Marketing Agents can be held for any inaccuracies, changes, losses or damages arising therefrom.