



## Flexible Working Solutions

### Redefining the Future of Workplaces

Riding on the shared economy and addressing emerging new ways of working, CapitaLand (Business Park & Industrial) diversified its offering of workplace solutions to include a 'space-as-a-service' model. Bridge+, The Workshop and CoSpace Park redefine future of workplaces, targeting different segments of the market with interesting and creative space offerings

**Bridge+** - [www.ourbridgeplus.com](http://www.ourbridgeplus.com)

Bridge+ is a community platform which brings together diverse entities and people. Bridge+ is set to pack a punch with value-add services designed around a collaborative culture and shared economies. Think social hubs for cross-company conversations, as well as enterprise-grade amenities such as meeting rooms and event spaces accessible by both members and public. This flagship space is located at Ascent in Singapore Science Park 1.

For booking and enquiries, please email [hello-sg@ourbridgeplus.com](mailto:hello-sg@ourbridgeplus.com).

### Ascent

2 Science Park Drive, Singapore Science Park 1, Singapore 118222



### 79 Robinson Road

79 Robinson Road, Singapore 068897

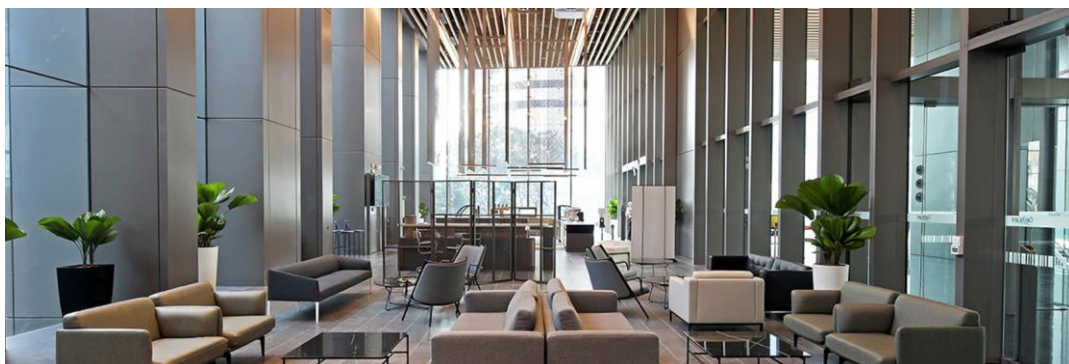



**Cospace Park** - [www.cospacepark.com](http://www.cospacepark.com)

**Sparkle**

43 Science Park Road, Singapore Science Park 2, Singapore 117408  
For booking and enquiries, please email [hello@cospacepark.com](mailto:hello@cospacepark.com)



Launched in late 2017, CoSpace Park offers a community-focussed working environment for businesses from start-ups to corporate innovation team predominantly thriving in disruptive technology. In collaboration with venture capital fund TNB Ventures, it also creates an ecosystem featuring start-ups as “co-innovators” to engage the park community with value-added services, whereby the start-ups are also able to connect with investors and the corporates, very much akin to a community centre in the Singapore Science Park 2.



**The Workshop** – [www.theworkshop.sg](http://www.theworkshop.sg)

Located at Aperia at Kallang Avenue and Techplace II in a light industrial estate in Ang Mo Kio Ave 5, The Workshop is a collaborative industrial workplace where SMEs and start-ups can realise their dreams. With flexible solutions and connections to like-minded community, The Workshop is a place where there is no limitations on what's possible.

For booking and enquiries, please call: 6717 7722 or email [enquiries@theworkshop.sg](mailto:enquiries@theworkshop.sg).

**The Workshop @ Ang Mo Kio**

5008 Ang Mo Kio Avenue 5, Techplace II #04-09/16, Singapore 569874

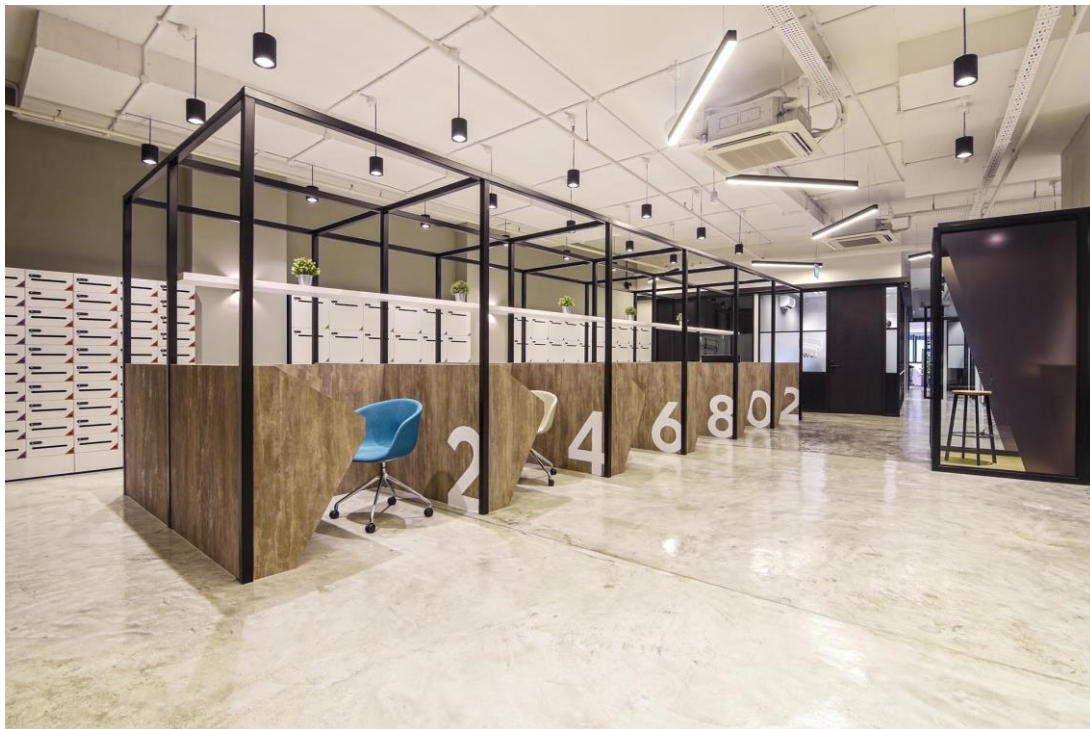



**The Workshop @ Lavender**

12 Kallang Avenue, Aperia #01-56, Singapore 339511



**The Workshop @ Bukit Merah**

1 Jalan Kilang Timor, Pacific Tech Centre #06-01, Singapore 159303

